



Meaningful Innovation.

WEEE Number: 80133970

## INSTRUCTION MANUAL

### LED SPIKE LIGHT

#### TECHNICAL DATA

MODEL	VT-80070
SKU	24004, 24005
WATTS	10W
LUMENS	880 lm
INPUT VOLTAGE	AC:220-240V, 50Hz
BODY TYPE	Aluminium+Iron
ON/OFF CYCLES	>15000
LED CHIP TYPE	COB
BEAM ANGLE	40°
CRI	>80
LONG LIFE	20,000 Hours
IK RATING	IK06
DIMENSION	248x78x100mm



**IP65**  
**RATING**

**02** **YEAR**  
**WARRANTY\***

#### INTRODUCTION & WARRANTY

Thank you for selecting and buying V-TAC product. V-TAC will serve you the best. Please read these instructions carefully before starting the installation and keep this manual handy for future reference. If you have any another query, please contact our dealer or local vendor from whom you have purchased the product. They are trained and ready to serve you at the best. The warranty is valid for 2 years from the date of purchase. The warranty does not apply to damage caused by incorrect installation or abnormal wear and tear. The company gives no warranty against damage to any surface due to incorrect removal and installation of the product. The products are suitable for 10-12 Hours Daily operation. Usage of product for 24 Hours a day would void the warranty. This product is warranted for manufacturing defects only.

#### WARNING

- Please make sure to turn off the power before starting the installation.
- Installation must be performed by a qualified electrician.
- Proper grounding should be ensured throughout the installation.

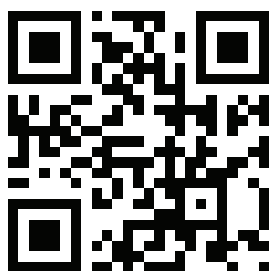

#### MULTI-LANGUAGE MANUAL QR CODE

Please scan the QR code to access the manual in multiple languages.



FR

Cet appareil,  
ses accessoires  
et cordons  
se recyclent

À DÉPOSER  
EN MAGASIN



À DÉPOSER  
EN DÉCHÈTERIE



OU

Points de collecte sur [www.quefairedemesdechets.fr](http://www.quefairedemesdechets.fr)  
Privilégiez la réparation ou le don de votre appareil !



This marking indicates that this product should not be disposed of with other household wastes.

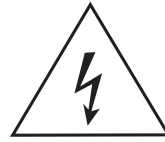

Caution, risk of electric shock.

## INSTALLATION INSTRUCTIONS

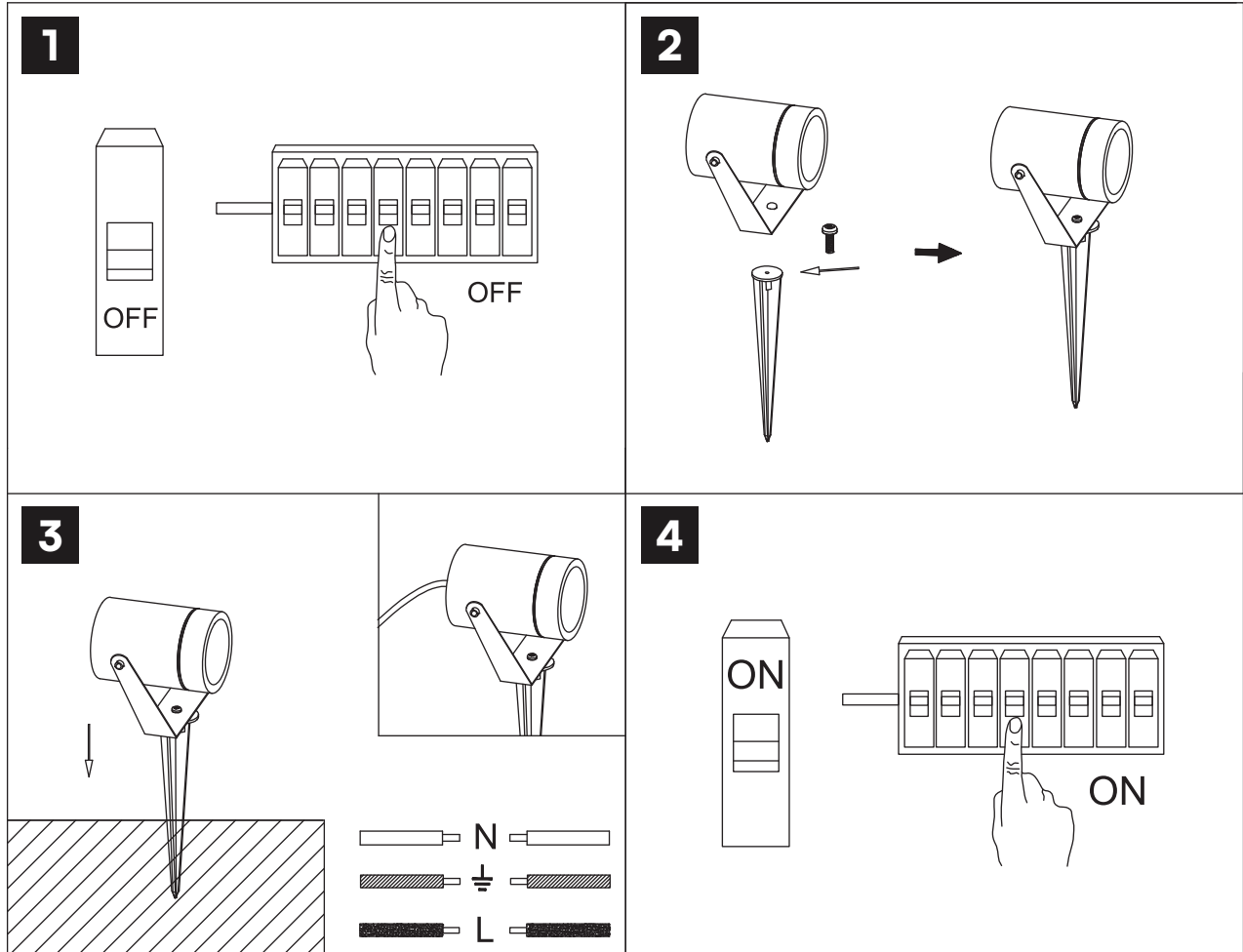

1. Turn off the power before starting the installation.
2. Assemble the light fixture and secure it to the stake with the screw.
3. Connect wires as per the diagram provided.
4. Secure the spike in the desired location.
5. Turn on the power and test the light.



**V-TAC WEST EUROPE LTD.** IN CASE OF ANY QUERY/ISSUE WITH THE PRODUCT, PLEASE REACH OUT TO US AT: [SUPPORT@V-TAC.EU](mailto:SUPPORT@V-TAC.EU)  
FOR MORE PRODUCTS RANGE, INQUIRY PLEASE CONTACT OUR DISTRIBUTOR OR NEAREST DEALERS.  
V-TAC WEST EUROPE LTD. GROUND FLOOR, 71 LOWER BAGGOT STREET, DUBLIN 02, IRELAND D02 P593

**V-TAC UK LTD.** IN CASE OF ANY QUERY/ISSUE WITH THE PRODUCT PLEASE REACH OUT TO US AT  
[SUPPORT@VTACEXPORTS.COM](mailto:SUPPORT@VTACEXPORTS.COM) V-TAC, 5A TUNGSTEN PARK, DOWNS ROAD, WITNEY, OXFORDSHIRE, OX29 0AX