



Meaningful Innovation.

WEEE Number: 80133970

## INSTRUCTION MANUAL

### LED EMERGENCY LIGHT



**IP40**  
**RATING**

**03** **YEAR**  
**WARRANTY\***

### INTRODUCTION & WARRANTY

Thank you for selecting and buying V-TAC product. V-TAC will serve you the best. Please read these instructions carefully before starting the installation and keep this manual handy for future reference. If you have any another query, please contact our dealer or local vendor from whom you have purchased the product. They are trained and ready to serve you at the best. The warranty is valid for 3 years from the date of purchase. The warranty does not apply to damage caused by incorrect installation or abnormal wear and tear. The company gives no warranty against damage to any surface due to incorrect removal and installation of the product. This product is warranted for manufacturing defects only. The products are suitable for 10-12 Hours Daily operation. Usage of product for 24 Hours a day would void the warranty. This product is warranted for manufacturing defects only.

### WARNING

- Please make sure to turn off the power before starting the installation.
- Installation should only be performed by a certified electrician.
- The light source of this luminaire is not replaceable; when the light source reaches its end of life the whole luminaire shall be replaced.
- If the external flexible cable or cord of this luminaire is damaged, it shall be exclusively replaced by the manufacturer or his service agent or a similar qualified person in order to avoid a hazard.
- For Indoor use only.

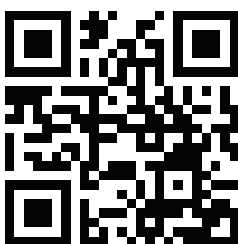

### MULTI-LANGUAGE MANUAL QR CODE

Please scan the QR code  
to access the manual in  
multiple languages.



**FR**  
Cet appareil,  
ses accessoires,  
cordons et batteries  
se recyclent

À DÉPOSER  
EN MAGASIN



À DÉPOSER  
EN DÉCHÈTERIE



OU

Points de collecte sur [www.quefairedemesdechets.fr](http://www.quefairedemesdechets.fr)  
Privilégiez la réparation ou le don de votre appareil !

IN CASE OF ANY QUERY/ISSUE WITH THE PRODUCT, PLEASE REACH OUT TO US AT: [SUPPORT@V-TAC.EU](mailto:SUPPORT@V-TAC.EU)  
FOR MORE PRODUCTS RANGE, INQUIRY PLEASE CONTACT OUR DISTRIBUTOR OR NEAREST DEALERS.  
V-TAC EUROPE LTD. BULGARIA, PLOVDIV 4000, BUL.L.KARAVELOW 9B

## TECHNICAL DATA

MODEL	VT-511
SKU	899-6
POWER CONSUMPTION	3.8W Max
LUMENS	110 Lm
LED	SMD 2835 20PCS
OUTPUT VOLTAGE	4.5V
OUTPUT POWER	1.2W
VIEWING DISTANCE	22 Meters
CHARGING TIME	12H
DISCHARGE TIME	≥4H
CHARGE CURRENT (MA)	200mA
DISCHARGE CURRENT (MA)	360mA
SAFETY CLASSIFICATION	II
PRODUCT MATERIAL	ABS+PC
BATTERY	3.7V, 2000mAh, Li-ion Battery
MODE OF OPERATION	Non-Maintained / Maintained
INPUT POWER	AC: 220-240, 50/60Hz
LEGENDS AVAILABLE	4 Ways Different Legends
DIMENSION	292x79x102mm
DIMENSION WITH RECESSED BOX	292x93.7x102mm



This marking indicates that this product should not be disposed of with other household wastes.



Caution, risk of electric shock.

## EMERGENCY LUMINAIRE DESIGNATION

X	2	A*C*E	180
---	---	-------	-----

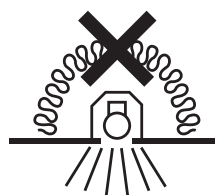

Luminaires not suitable for covering with thermally insulating material.

## INSTALLATION INSTRUCTIONS

NOTE: Jumper cap switching position has the functions of AC/DC (Maintained) and DC (non-maintained). P1 is AC/DC position, P2 is DC position. (Refer to Picture F)

**Note:** We do not recommend any modification to this product. Any modification may render the product to be unsafe and will invalidate any Safety /Approvals.

### WARNING

- Perform a daily check to ensure the green LED status indicator is illuminated.
- Do not install this product on damp or freshly plastered surfaces.

## THREE INSTALLATION METHODS

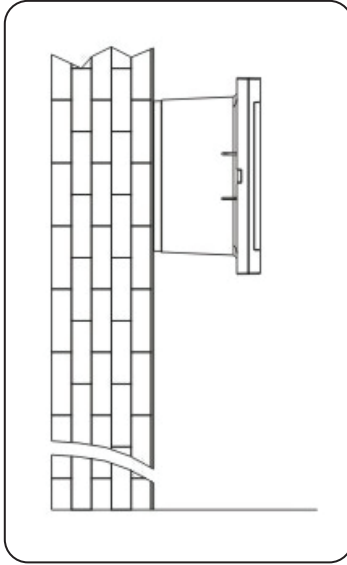

1. Wall Mounting

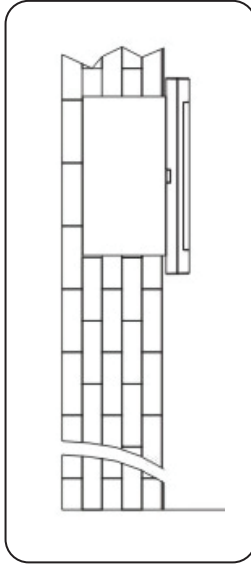

2. Flush Mounting

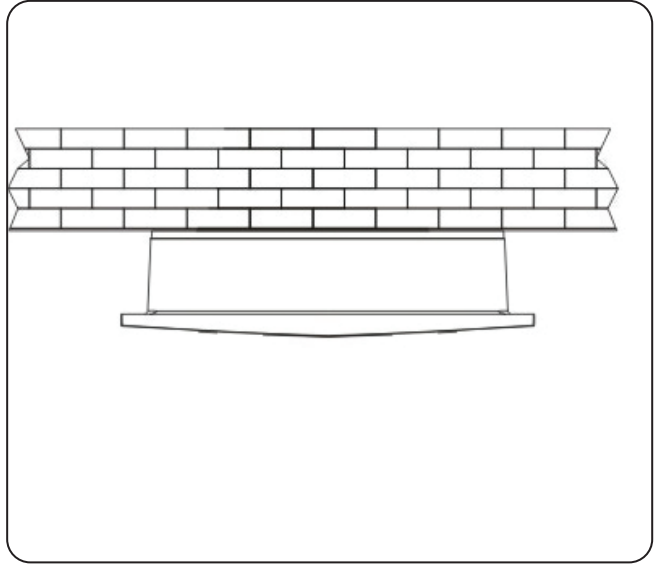

3. Ceiling Mounting

## I SURFACE MOUNTING (FOR WALL ONLY)

1. Switch off the main power before installation
2. Open the emergency light with a help of a screwdriver (Figure A).
3. Insert the Lead wires from the wall through the hole base cover as shown in (Figure B).
4. Install the base cover on the wall with the help of screws.
5. For connecting the wires, pull out the connector from the front cover, unscrew the screws on them and connect the lead wires to PCB AC and green terminal.
6. Put back the connector on the front cover.
7. Place back the front cover on the base
8. Switch on the main power

## RECESSED INSTALLATION

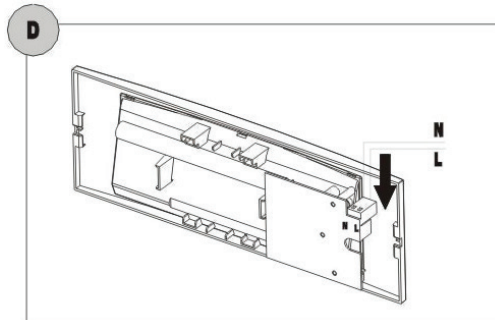
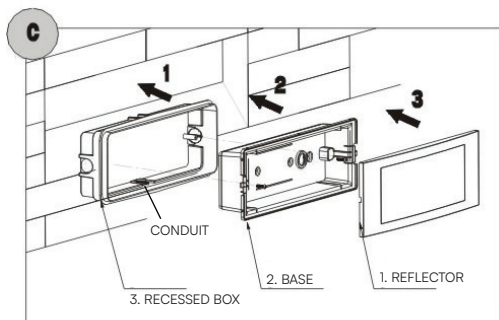
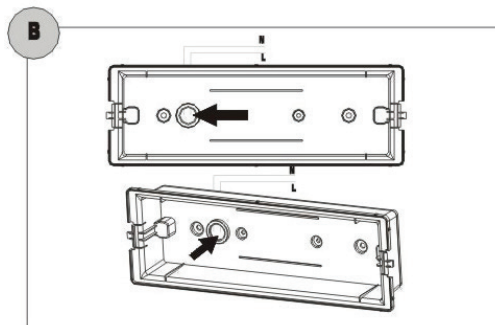
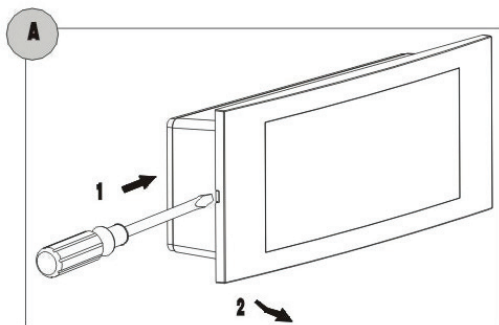

---

## II RECESSED/FLUSH MOUNTING (FOR WALL ONLY)

1. Switch off the main power before installation
2. Push the conduit of the recessed box with a screwdriver
3. Open the emergency light with a help of a screwdriver (Figure A).
4. Place the Recessed Box on the Wall cutting and Insert the Lead wires from the wall through the Recessed box and base cover hole as shown in (Figure B).
5. For connecting the wires, pull out the connector from the front cover, unscrew the screws on them and connect the lead wires to PCB AC and green terminal.
6. Put back the connector on the front cover.
7. Place back the front cover on the base
8. Switch on the main power

## OPERATION

1. If the AC power is normal, the green charging indicator will be ON which shows the lamp is charging.
2. If a power failure occurs, the emergency light senses the AC power failure and automatically switches to emergency mode. The emergency light will illuminate for a minimum of 4 hours. When the AC power is restricted, the emergency light switches the system back to normal mode and resumes battery charging.

## MAINTENANCE

Use a small cotton swab with cleaning alcohol to clean the unit, never use strong or volatile chemicals to clean the unit as it will damage the plastic parts.

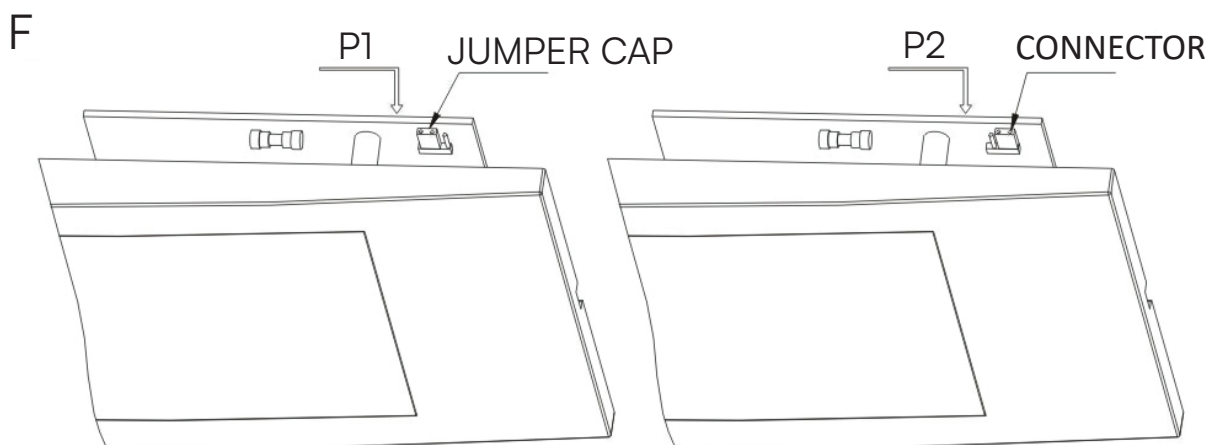

---

## IMPORTANT NOTES

- This product contains battery type "Secondary" (rechargeable).
- Electrical and electronic equipment that has become waste is known as old equipment/device. Old devices must not be disposed of with other household waste.
- Owners of old devices at the end of its service life must return the device by taking them to the collection points set up by public waste disposal authorities or distributors. This return does not entail any costs for you.
- Owners of old devices have an obligation to remove accessible batteries / rechargeable batteries as well as non-destructively removable lamps from the old device prior to return. This does not apply if old devices are being prepared for reuse with the participation of a public law firm.
- Battery removal warning: The battery contained in this product must be removed only by professional personnel only. The battery must never be removed by the end user, if not removed correctly it could damage the battery which could cause fire.
- Batteries removed from an old electronic device should be disposed of separately. This return of battery does not entail any costs for you and the user is obliged to return the battery.
- Please make sure that this product is not powered on when removing the battery. Fire hazard! Avoid short-circuiting the contacts of a detached battery. Do not incinerate the battery. Please handle the battery with Caution!
- If electrical appliances or batteries are disposed of in landfills or dumps, hazardous substances can leak into the groundwater and get into the food chain, damaging your health and well-being.



- The symbol of "Crossed rubbish bins" indicates that this product should not be disposed of with other household wastes and must be collected separately from unsorted municipal waste at the end of its service life.
- Please use the link below to view the online directory of the collection and return points: <https://www.ear-system.de/ear-verzeichnis/sammel-und-ruecknahmestellen>



**V-TAC WEST EUROPE LTD.** IN CASE OF ANY QUERY/ISSUE WITH THE PRODUCT, PLEASE REACH OUT TO US AT: SUPPORT@V-TAC.EU FOR MORE PRODUCTS RANGE, INQUIRY PLEASE CONTACT OUR DISTRIBUTOR OR NEAREST DEALERS. V-TAC WEST EUROPE LTD. GROUND FLOOR, 71 LOWER BAGGOT STREET, DUBLIN 02, IRELAND D02 P593

**V-TAC UK LTD.** IN CASE OF ANY QUERY/ISSUE WITH THE PRODUCT PLEASE REACH OUT TO US AT SUPPORT@VTACEXPORTS.COM V-TAC, 5A TUNGSTEN PARK, DOWNS ROAD, WITNEY, OXFORDSHIRE, OX29 OAX

---